

# 聯軸器型扭力限制器 Torque Limiter with Coupling

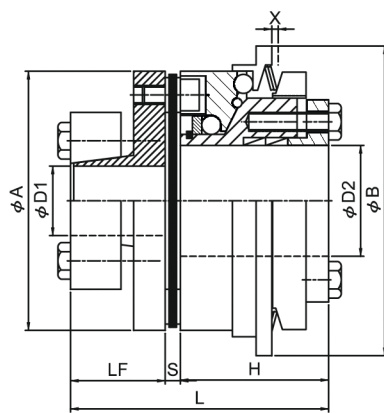

- 可取代聯軸器使用 / Substitute for Coupling
- 可精確的傳動扭力 / Precise Transmissible Torque
- 無背隙單點復歸 / Backlash-free, Regression-to-origin
- 具有偵測過載功能 / Overload Detectable
- 耐用免保養壽命長  
Endurable, Maintenance-free and Infinite Life



SWT

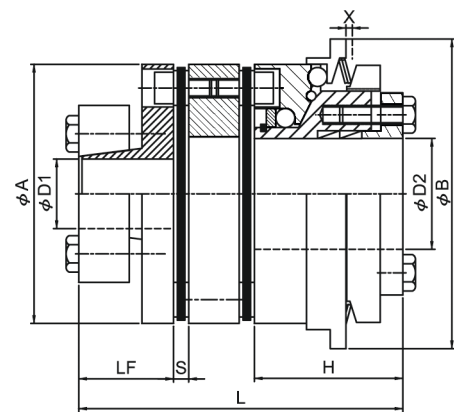

SWLT

## ◆特性表 / Specification

單位/unit:mm

		扭力範圍 Torque Range (Kgf·m)	A	B	扭力限制器側 Limiter Side D1	聯軸器側 Coupling Side D2	LF	S	H	L	X	最高轉速 Max. Rotational Frequency (rpm)	重量 kg
SWT-68	A	1~3	68	78	15~25	14~30	25	4.2	45	74.2	1	3000	1.3
	B	2~6											
SWT-82	A	2~7.5	82	98	20~35	16~35	30	4.8	47	81.8	1	2000	1.8
	B	4~15											
SWLT-68	A	1~3	68	78	15~25	14~30	25	4.2	45	94.4	1	3000	1.6
	B	2~6											
SWLT-82	A	2~7.5	82	98	20~35	16~35	30	4.8	47	102.6	1	2000	2.0
	B	4~15											

## ■ SWT/SWLT 選用方式 / Ordering Specification

SWT/SWLT-  -  -

外徑                      D1                      D2

Outer Diameter